

halfords

Steamcleaner

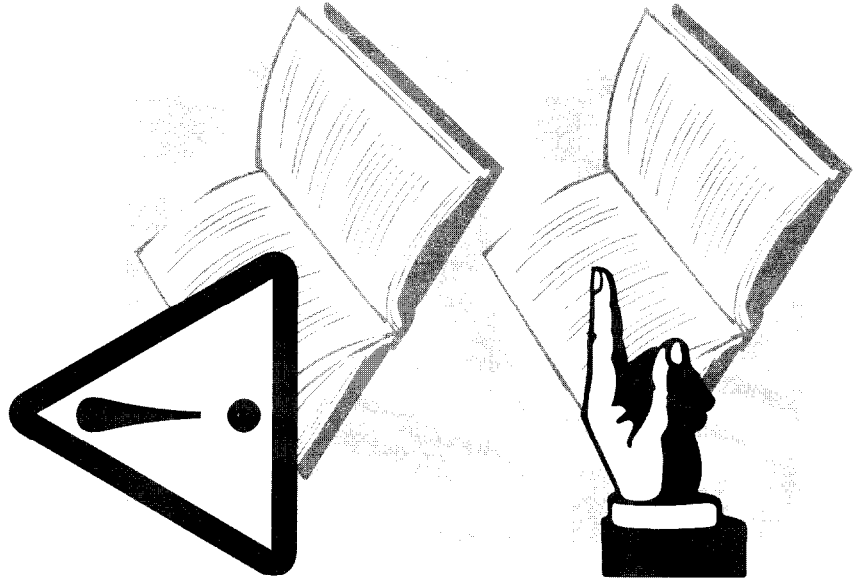

ARNING: READ THE INSTRUCTIONS CAREFULLY BEFORE USE

STANDARD EQUIPMENT

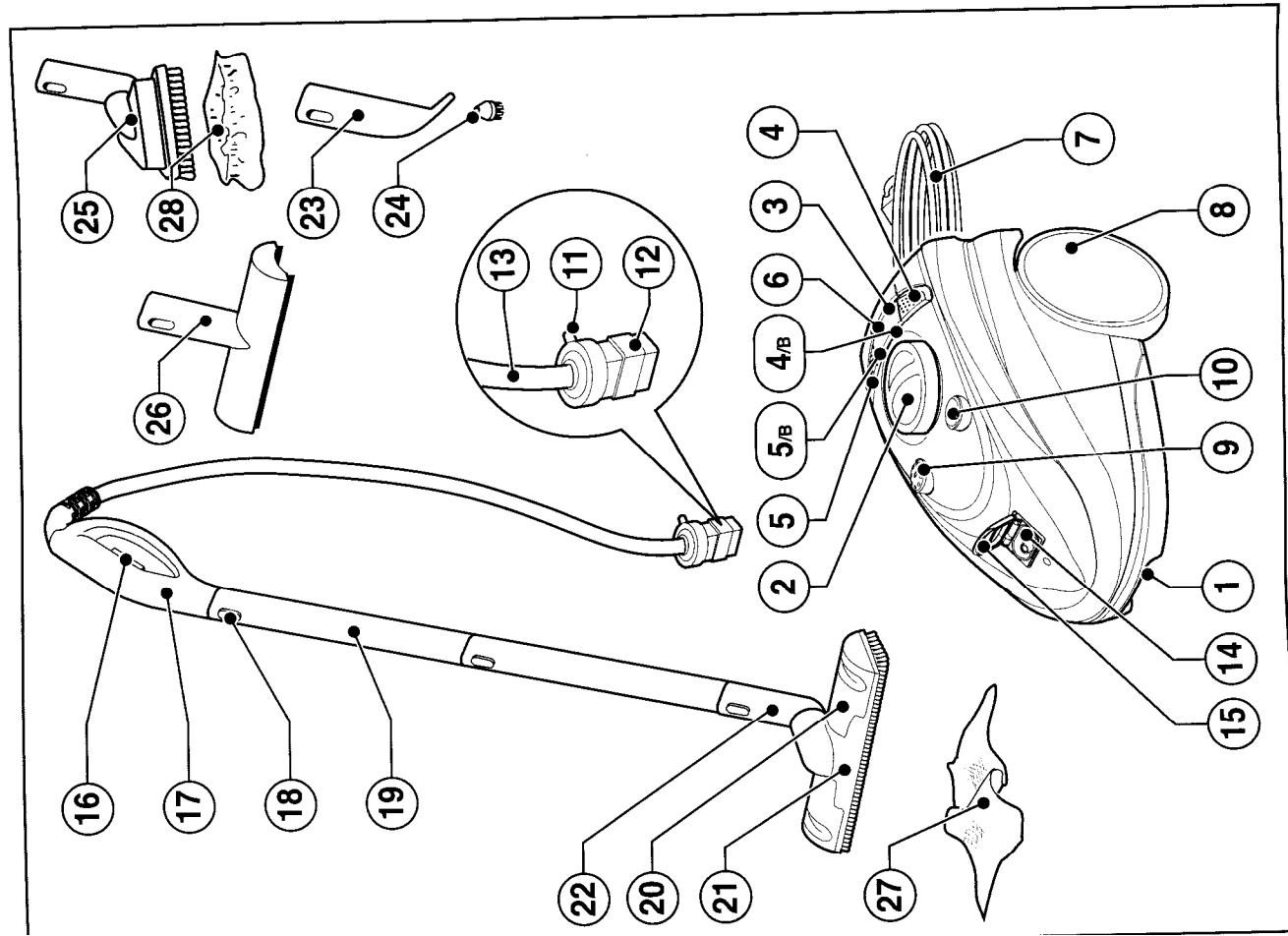

Parts of the steam cleaner:

- 1 Handle
- 2 Boiler cap
- 7 Plug and power cord
- 8 Wheels
- 9 Steam intensity regulator
- 10 Heat indicator
- 11 Safety pin
- 12 Quick coupler plug
- 13 Steam hose
- 14 Quick coupler socket
- 15 Safety cap
- 16 Steam lever
- 17 Steam nozzle handle
- 18 Spring button
- 19 Extension pipes
- 20 Cloth holding clamps
- 21 Scrubbing brush with clamps
- 22 Brush-joint
- 23 Bent nozzle
- 24 Small brush
- 25 Triangular brush
- 26 Window cleaner
- 27 Rectangular cotton cloth
- 28 Triangular cotton cloth

CONTROLS PANEL

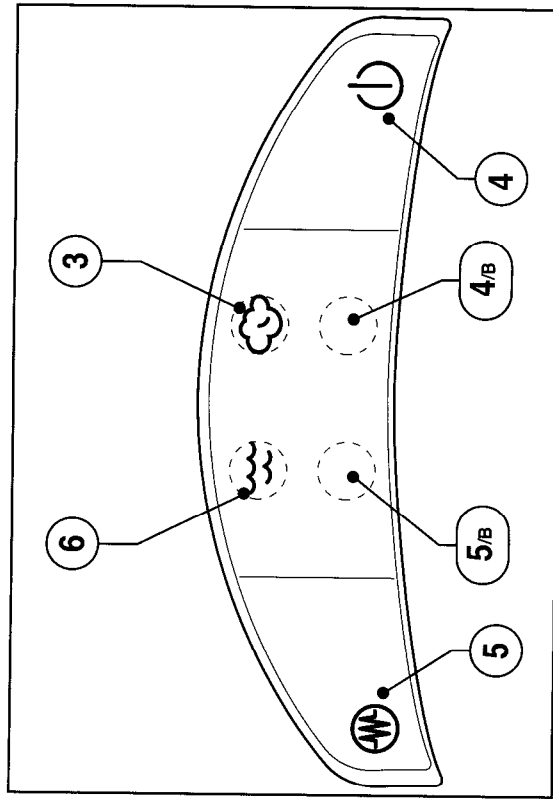

Parts of the steam cleaner:

- 3 Steam pressure lamp (green)
- 4 Main switch
- 4/B On-Off switch light (orange)
- 5 Heating switch
- 5/B Heater switch light (green)
- 6 Water indicator lamp (orange)

This Operation and Maintenance Manual reports the symbols indicated below, in order to draw your attention to special information.



Caution!

It is important to be careful on safety grounds.



Warning:

It contains some additional information and useful advice on the correct use of the machine.

This machine complies with the latest European provisions in this matter and has a high quality and safety standard. This Operation and Maintenance Manual describes the many ways of using the steam cleaner.

Caution!

This Operation and Maintenance Manual is an integral part of the machine itself. Please read this Manual very carefully before starting the machine. Please keep this Manual as a reference book in case of need.



Warning:

Scald danger

Useful information on steam cleaning:

Water in the form of steam has an ecological cleaning action and is superior to modern detergents. In the form of steam, water is used sparingly. The steam produced by the machine because of the high temperature reached dissolves fats and dust particles which are normally hard to remove.

Steam has an hygienic cleaning action and leaves no way out to bacteria, mites, germs, pathogens; it binds dust particles, thus preventing dust from causing any allergies.

You can benefit from all these advantages by using the steam cleaner for your household works and at the same time you can make your contribution to the environment.

Please observe the safety measures contained herein.

- Remove the plug from the socket before replacing any accessory or filling the boiler with water, or when you don't use the machine.
- Connect the machine only if the mains voltage corresponds to the voltage reported on the rating plate.
- Never unplug the steam cleaner by pulling the power cord.
- If an extension cord is used the plug and socket must be of watertight construction.
- **WARNING.** Inadequate extension cord can be dangerous.
- Before starting the machine, make sure that the power cord, the plug and the steam hose aren't damaged.
- Never, splash, wash down or plunge the machine into water or into other liquids.
- Never obstruct the steam outlet.
- Never direct the steam jet towards people, animals, trees or towards particularly cold or hot objects.
- Don't clean household appliances or electrical connections-such as sockets or control boards-with the steam cleaner.
- No user serviceable parts inside refer servicing to qualified service personnel.
- This machine must be repaired by a trained technician only.
- Steam cleaners shall not be used by children or untrained personnel
- Children don't know the perils of household appliances; therefore keep them off the working area.
- Never use the steam cleaner to clean electric cookers.
- Do not use in swimming pools containing water.
- Never work with wet hands
- When machine is in operation do not cover the machine, it could become overheated.
- If you lend your steam cleaner to other people, it is necessary to give them this Operation and Maintenance Manual as well.

Important Advice

⚠ Caution!

- Always make sure that the materials or the surfaces to be cleaned are suitable for the steam cleaner.
- Follow the manufacture instructions about the cleaning of materials.
- If no information is available, make always a trial on a little visible point of the material. Should any damage appear, don't use the steam cleaner.

- Only professionally qualified personnel must be allowed to replace the electric cable.
- Always use the accessories recommended.
- Always put a cotton cloth on the brushes to avoid scratches.
- On vertical surfaces, always work from the top to the bottom. Put a cloth under the surface to be cleaned, to collect dirt.
- Use the extension pipes only if necessary.
- Steam clean small areas at a time. The dirt just dissolved can be removed more easily.
- In case of dirt hard to remove, treat the surfaces directly with the steam jet.
- To remove stains from upholstered furniture or carpets, spray the steam on dirt, then run the triangular brush over the surface gently, without exerting any pressure. Let the treated surface get dry and see if the stain has disappeared. In case the result shouldn't be satisfactory, repeat this procedure.
- On delicate surfaces, such as wood surfaces, spray a little steam quantity and dry immediately.
- Carpets must be cleaned first with the vacuum cleaner and then with the steam cleaner.

⚠ Warning

- The steam jet can't remove any lime deposits; these must be removed by using ecological vinegar.

Field of application

The steam cleaner is suitable for cleaning:

Wide surfaces, such as:

- Tiled floor, parquet, stone and linoleum floor.
- Tiled floor treated with wax (wax removal)
- Tiles or tiled walls
- Roller shutters, guillotine windows
- Carpets

Small surfaces, such as:

- Interstices of heat radiators, tiles, skirting boards
- Door or window frames
- Shutters

Glass surfaces, such as:

- Windows, glass walls
- Glass doors
- Mirrors

Upholstery, such as:

- Carpets and moquettes
- Upholstered furniture (sofas, armchairs)

⚠

Caution!

- Furniture surfaces can be treated with the steam cleaner, on the following conditions:
 - Never clean with the direct steam jet.
 - Always use a soft absorbent cloth
 - Work with little steam pressure
 - When you clean, don't exert any pressure with the brush.

⚠

Warning

- With the iron special accessory, you can iron your underwear or refresh clothes.

Start the steam cleaner

Fill with water

⚠

Caution!

- Before filling the boiler with water, unplug the machine.
 - Fill the steam cleaner only with normal tap water or with distilled water.
 - The steam cleaner must rest on a plane surface
- ⇒ Press the boiler cap (2) downwards and turn it anticlockwise at the same time, so as to unscrew it completely.
- ⇒ Pour an adequate water quantity (min. 0.5 l - max. 1.6 l) into the boiler.
- ⇒ Put the cap on the boiler: press it downwards and turn it clockwise at the same time, so as to screw it tight.

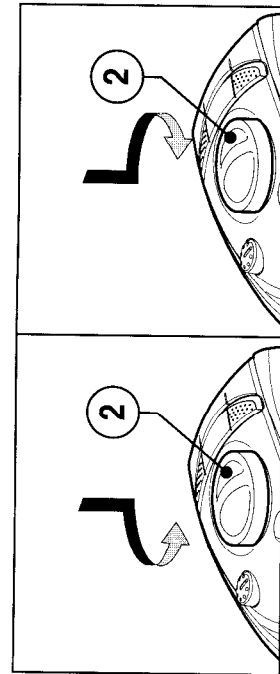

⚠

Caution!

- Make sure that the boiler cap is properly closed.

Connect the steam cleaner

⚠ Caution!

- Connect the machine only if the mains voltage corresponds to the rated voltage reported on the rating plate.
 - The main switch (4) and the heating switch (5) must be disconnected.
 - The power cord (7) must not be damaged.
 - The hose must be filled with a sufficient water quantity (min. 0.5 l)
 - The hose must be connected to the relevant accessory.
 - The steam nozzle must not be obstructed.
- ⇒ Push the main switch (4); an orange light will appear (4/B).
- ⇒ Push the heating switch (5); a green light will appear (5/B).
- ⇒ The machine is in operation.
- ⇒ Water is heated and steam is generated.
- ⇒ When the green lamp lights up (3) the machine is ready to work.

Pour water into the boiler

⚠ Caution!

- When the machine is working, don't open the boiler cap (2)!
- The boiler cap may be supplied with an optional security. This security prevents the cap unscrewing in case the boiler still contains steam

⚠ Warning

- When the boiler water is finished, the orange water indicator lamp will light up (6).

Filling

- ⇒ Disconnect the heating switch (5).
- ⇒ Keep the steam nozzle in the wash-basin.
- ⇒ Push the steam lever (16) on the handle and keep it pressed until all steam has come out.
- ⇒ Move the electrical plug (7) from the supply socket.
- ⇒ Let the steam cleaner cool down.
- ⇒ Press the boiler cap (2) downwards and turn it anticlockwise at the same time, so as to unscrew it completely.
- ⇒ Pour water into the boiler.
- ⇒ Put the cap on the boiler: press it downwards and turn it clockwise at the same time, so as to screw it tight.

Disconnect the steam cleaner

- ⇒ Disconnect the heating switch (5) and the main switch (4).
- ⇒ Turn the steam intensity regulator (9) on position 0.
- ⇒ Pull out the electrical plug (7) from the supply socket.
- ⇒ Let the steam cleaner cool down.

Fit or remove accessories

⚠

Caution!

- Never work with wet hands
- The steam cleaner must be disconnected
- Accessories get hot when the machine is working. Be careful when replacing the accessory during operation.

Fit the extension pipe

- ⇒ Push the spring button (18) on the steam nozzle handle (17)
- ⇒ Fit the steam nozzle handle (17) into the sleeve of the extension pipe (19) until the spring button (18) snaps.

Fit the brushes

- In order to be able to use the rectangular or the triangular scrubbing brush, it is necessary to connect the brush-joint (22) first:

- ⇒ Keep the brush-joint downwards pointed and insert it completely into the brush. Turn then the brush-joint upwards pointed.
- ⇒ Push the spring button (18) on the steam nozzle handle (17) or on the extension pipe (19).
- ⇒ Fit the brush-joint (22) into the steam nozzle handle (17) or into the extension pipe (19), until the spring button (18) snaps.

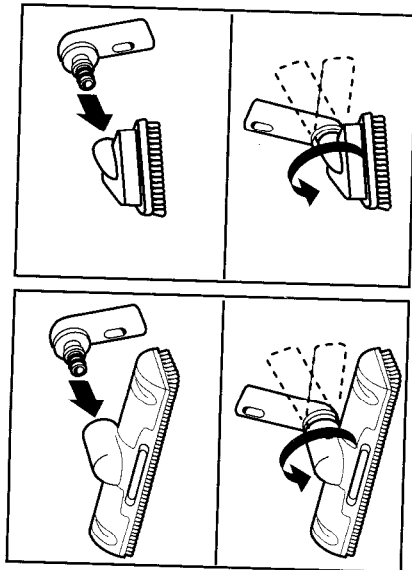

Remove the pipe and the brushes

- ⇒ Push the spring button (18) on the steam nozzle handle (17) or on the extension pipe (19).
- ⇒ Remove the extension pipe (19) or the brush-joint (22) from the steam nozzle handle (17).
- ⇒ Keep the brush-joint downwards pointed and remove the brush from the brush-joint

Connect or remove the steam hose

Caution!

- Ensure that the power cord and the steam are undamaged prior to each use.
- The steam cleaner must be unplugged.
- Work only with dry hands

Connect the steam hose

- ⇒ Lift the safety cap (15).
- ⇒ Push the quick coupler plug (12) into position and align the safety pin (11) with the hole in the cap (15).
- ⇒ Release the safety cap (15).

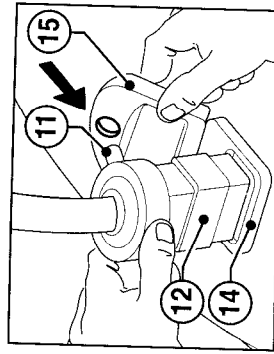

Cleaning of glass

⚠ Caution!

- Ensure the safety pin (11) is fully secure.

Remove the steam hose

- ⇒ Disconnect the heating switch (5).
- ⇒ Keep the steam nozzle (17) in a wash-basin
- ⇒ Push the steam lever (16) on the handle until the remaining steam has completely come out of the boiler.
- ⇒ Disconnect the main switch (4).
- ⇒ Move the electrical plug (7) from the supply socket.
- ⇒ Lift the safety cap (15).
- ⇒ Remove the quick coupler plug (12).

Put a protection cloth



Warning:

- Cotton cloths are used to protect surfaces from scratches.
- Be careful! Cloths become hot while you do the cleaning.
- Change the cloth only after unplugging the steam cleaner!
- Dirty cloths can be washed in the washing-machine.
- ⇒ Put a protection cloth (27) on a plane surface.
- ⇒ Lay the scrubbing brush (21) in the middle of the cloth.
- ⇒ Push the cloth holding spring clamps (20) and keep them pressed.
- ⇒ Put two corners of the cloth under the spring clamps (20) from behind.
- ⇒ Now put the front half of the cloth under the spring clamps (20) and release them.

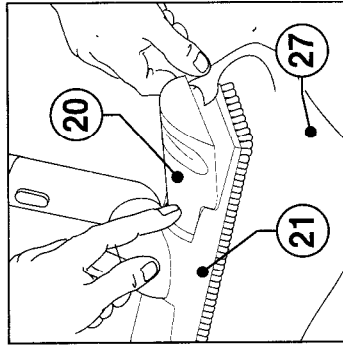

Put the cotton cap on the triangular brush

- ⇒ This cotton cap (28) is properly designed to fit the triangular brush (25).

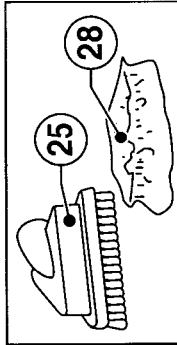

Fit the small brush



Warning:

- The small brush (24) must be used only together with the bent nozzle (23).
- ⇒ Fit the small brush (24) into the bent nozzle (23).
- ⇒ Fit the bent nozzle (23) into the extension pipe (19) or into the steam nozzle handle (17).

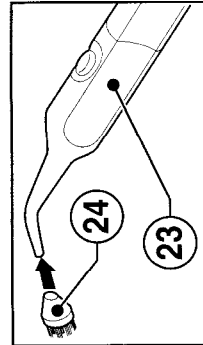

Caution!

- If external temperatures are around the freezing-point, the window glass can be slightly sprayed with steam at a distance of cm. 20, at least.
- After that, you can treat the whole glass surface with steam to offset sudden changes in temperature and to avoid tensile stress on the glass surface.
- Sudden changes in temperature between glass and steam can break the glass.

Fit the window cleaner

- ⇒ Push the spring button (18) on the steam nozzle handle (17) or on the extension pipe (19).
- ⇒ Fit the window cleaner (26) into the steam nozzle handle (17) or into the extension pipe (19) until the spring button (18) snaps.

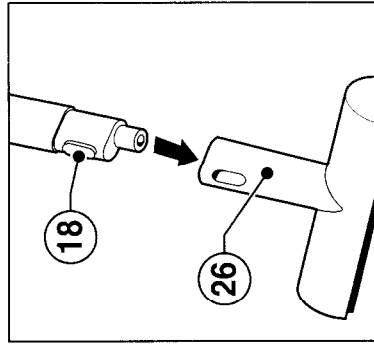

Warning:

- Very dirty windows must be cleaned first with the small or big brush and the cloth.
- Then, you can clean the window with the window cleaner.
- After cleaning, remove dirt from the rubber band of the window cleaner with a clean cloth. Only a clean and well stretched band allows a perfect cleaning of the window without stripes.
- ⇒ Spray the window with steam from the top to the bottom
- ⇒ Remove dirt with the rubber sponge.
- ⇒ Lay the wiper rubber band on a part of the window treated with steam.

OPTIONAL: Iron

Part No. Function

- 1/A Base..... isolated protection on which the iron can be placed.
- 2/A Steam switch..... steam discharge during ironing.
- 3/A Temperature lamp (orange)..... indicates when the iron is ready.
- 4/A Temperature regulator..... regulation of the ironing temperature desired.
- 5/A Steam hose (flex.) with coupler plug..... connection with steam cleaner.

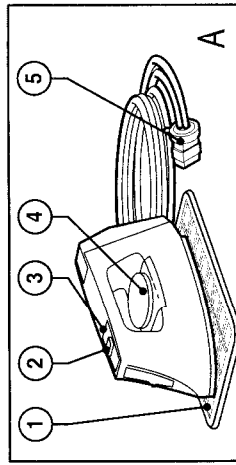

Please note:

this machine can be equipped with different types of irons, according to the accessories or technical specifications required.

If you need accessories please call 01925 631100.

Special accessory: iron (optional)



Caution!

- Don't work with wet hands
- Always move the plug from the socket before connecting the iron.
- The steam hose must not get in contact with the hot iron plate or with objects having sharp edges.
- Lay the iron only on the special base provided.
- Never leave the iron unattended if connected to the machine

Connect the iron

- ⇒ Pour water into the boiler (2) (see chapter "pour water into the boiler").
- ⇒ Lift the safety cap (15).
- ⇒ Insert the iron plug into the socket with the safety pin (11) turned upwards (see chapter "connect or remove the steam hose").
- ⇒ Release the safety cap (15).
- ⇒ Connect the machine (the main switch 4 and the heating switch 5).
- ⇒ Set the temperature desired on the iron temperature regulator.
- ⇒ Set the steam intensity on the steam regulator (9) on the machine.
- ⇒ As soon as the green lamp lights up (3), the unit is ready to be used.

Work with the steam cleaner



Caution!

- Follow the instructions on underwear and garment ironing.
 - ⇒ Direct the first steam jet to a cloth
 - ⇒ When you iron, push the steam button only at adequate distances.
 - ⇒ Let the iron slide lightly on the underwear.
 - ⇒ You needn't exert any excessive pressure.
 - ⇒ Always iron on a heat-resistant and steam permeable ironing surface.
 - ⇒ Iron only dry clothes.
 - ⇒ Select the proper ironing temperature according to the type of fabric.
 - ⇒ Follow the instructions reported on garment labels.
 - ⇒ Always iron perfectly dry clothes to avoid any further creases.
 - ⇒ Iron delicate garment reverse side.

Table: steam ironing

Type of fabric	Steam intensity
Linen/Cotton	3-4
Light cotton	3
Wool/Silk	1
Synthetic materials	1

Refreshing of clothes

- ⇒ Set the temperature desired on the iron temperature regulator (4/A).
- ⇒ Set the steam intensity regulator (9) on 3-4.
- ⇒ Spray hanging clothes with steam, at a distance of cm. 20.
- ⇒ With delicate fabrics, you'd better put a clean cotton cloth on the garment, then you can treat them with steam.

Work with the steam cleaner



Warning:

- When you begin cleaning or ironing, or after a long pause, it's advisable to spray a little steam on a cloth, to eliminate any water residue from the steam hose.
- The cleaning action is determined by the steam intensity and not by the pressure exerted on the accessory.
 - ⇒ Set the steam intensity by the steam regulator.
 - ⇒ Push the steam lever (16) on the steam nozzle handle.
 - ⇒ Direct the steam jet towards the surface to be cleaned.
 - ⇒ Run the scrubbing brush uniformly over the surface
 - ⇒ If dirt is hard to eliminate, scrub just a little without pressing on the brush.
 - ⇒ Collect dissolved dirt with a cloth.

Table:

steam intensity recommended

Degree of dirt	Steam intensity
Dirt very easy to remove	1-2
Dirt easy to remove	3-4
Dirt hard to remove	5

Maintenance



Caution!

- Before any maintenance or cleaning, unplug the machine.
- Do not empty the machine as long as there is hot water inside the boiler.
- In order to avoid formation of scale, it is recommended to fill the boiler with water and empty it once a month (the machine can be emptied by setting it vertical).
- If the machine is to be kept idle for long periods of time, the boiler shall have to be emptied.
- Always allow the machine and accessories to cool down before putting these away.

How to store the steam cleaner

- Store the machine in vertical position and use the cable winder (optional).
 - ⇒ Extract the cable winder by pulling downwards.
 - ⇒ Insert the hoses into their seats and wind the cable onto the outward wings: the cable can be rolled even without fitting the hoses.

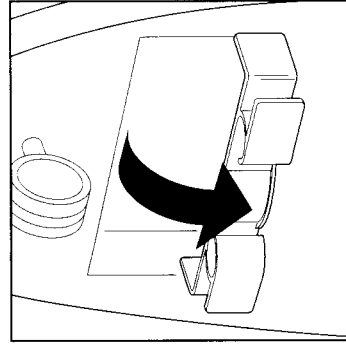

Cleaning

- Clean the machine with a damp cloth. Do not use solvents, this may cause damage.
- Every now and then clean the iron plate with a product suitable for metals. Then, run a dry cloth over it.
- Clean the machine accessories only with water.
- Let the clean brushes dry, with the bristles turned upwards, to avoid any deformations.

Helpful Hints

Caution!

- Repairs must be executed by an Authorized Service Centre, only.

Warning:

Failures may occur although the machine is used properly. The table below reports some failures and remedies.

If you experience any difficulty or require accessories or spare parts, please contact tel. no. 01925-631100.

Problem	Cause	Remedy
Immediately after connecting the machine, it emits a sound signal* (optional) and the lamp lights up	<ul style="list-style-type: none"> The water reserve in the boiler is not enough 	<ul style="list-style-type: none"> Pour some water into the boiler (see chapter about water)
The steam cleaner is ready to work, but no steam comes out	<ul style="list-style-type: none"> The nozzle connector hasn't been fitted properly The intensity regulator is on position 0 The accessory is obstructed 	<ul style="list-style-type: none"> Make sure that the plug is properly connected. Turn the steam intensity regulator on position 1-5. Check the accessories.
When you work with the steam cleaner, an accessory comes off	<ul style="list-style-type: none"> The accessory hasn't been connected properly 	<ul style="list-style-type: none"> Fit the accessory properly

Warranty conditions

All our machines are subjected to strict tests and are covered against manufacturing defects by a 12 month guarantee. The warranty runs from the date of purchase. The purchasing date shall be that indicated on the receipt issued when the Dealer delivers the machine. The manufacturer undertakes to repair free of charge those parts showing manufacturing defects within the warranty period, or to replace these free of charge. Defects not clearly attributable to materials or manufacture shall be examined by our Technical Assistance Center or in our plant and shall be charged according to the outcome of the examination. The guarantee shall not cover: accidental damage, caused by transport, neglect or inadequate treatment, incorrect or improper use and installation failing to comply with the indications in the instruction manual or in any case resulting from causes that do not depend on normal operation or use of the machine. The warranty becomes void when the machine has been repaired or replaced by unauthorized third parties. The warranty shall not cover replacement of the machine or extension of the guarantee resulting from a breakdown. Repairs shall be carried out in our Authorized Technical Assistance Center or in our plant. The machine shall reach us carriage free, i.e. with transport expenses at the user's charge. The warranty shall not cover any cleaning operations to which the operative components may be subjected. The manufacturer declines all responsibility for damage to persons or property caused by bad installation or incorrect use of the machine.

This does not affect your statutory rights.

Table about the use of your steam cleaner

Surfaces to clean	Steam jet intensity	Accessory
Wide surfaces <ul style="list-style-type: none"> Parquet, wood, linoleum Marble, stones Ceramics 	3 4 5	Scrubbing brush, extension pipes and cotton cloth
Small surfaces <ul style="list-style-type: none"> Skirting boards Interstices Slits Shutters 	2-4	Small or big brush, bent nozzle with or without the extension pipe
Upholstery <ul style="list-style-type: none"> Carpets Upholstered furniture 	3-4 2-3	Triangular brush, cotton cloth and extension pipe
Cleaning of glass: <ul style="list-style-type: none"> Windows 	3-5	Scrubbing brush, with wiper, extension pipes
Furniture: <ul style="list-style-type: none"> Delicate furniture (ex. lacquered furniture) Plastified furniture (kitchen furniture) 	1-2 2-3	Triangular brush, extension pipes and cotton cloth

Disposal



Information on Waste Disposal for Consumers of Electrical & Electronic Equipment

This mark on a product and/or accompanying documents indicates that when it is to be disposed of, it must be treated as Waste Electrical & Electronic Equipment (WEEE). Any WEEE marked waste products must not be mixed with general household waste, but kept separate for the treatment, recovery and recycling of the materials used. For proper treatment, recovery and recycling; please take all WEEE marked waste to your Local Authority Civic waste site, where it will be accepted free of charge. If all consumers dispose of Waste Electrical & Electronic Equipment correctly, they will be helping to save valuable resources and preventing any potential negative effects upon human health and the environment, of any hazardous materials that the waste may contain.

TECHNICAL DATA PLATE

Check if the technical data on the plate correspond to those of the main, to which the machine has to be connected.

TECHNICAL DATA

Total power	2350W
Boiler volume	2,4 l
Boiler capacity	1,6 l
Boiler draw rate	1500 W
Steam pressure	400 kPa (4 bar)
Operating temperature	145° C
Iron draw rate (optional)	850 W

ASSEMBLY INSTRUCTIONS

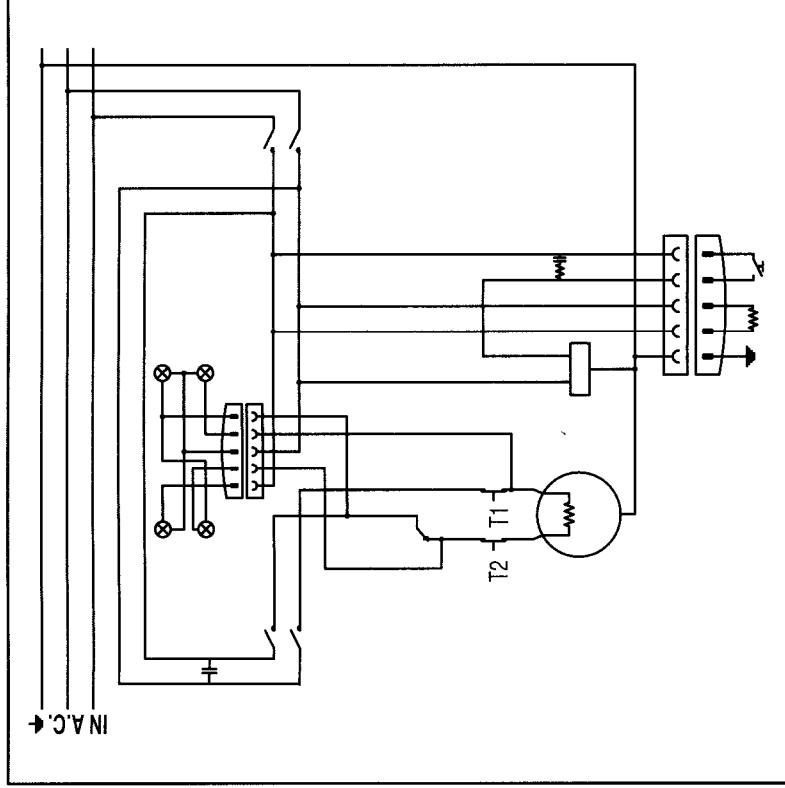
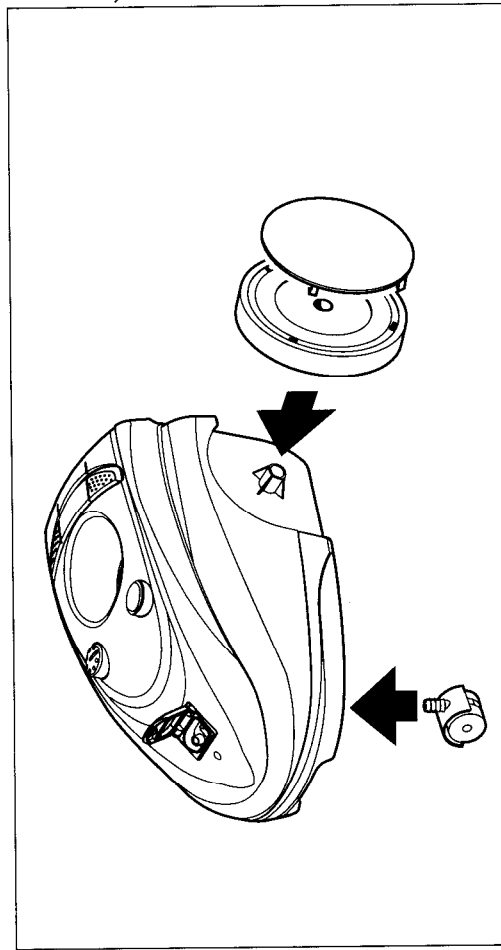

Safety features: Service pressure switch • Service thermostat • Safety thermostat
• Steam control on the waterproof handle • Tamper-proof cap with pressure release valve • Boiler in die-cast aluminium.

GB

CE CERTIFICATE OF CONFORMITY

The underwrite company:

LAVOR via J.F.Kennedy,12 Italy
46020 Pegognaga (MN)

Declares under its responsibility that the machine:

PRODUCT: Steam cleaner

MODEL TYPE: Silversteam

complies with directives 98/37/CEE, 73/23/CEE (+93/68/CEE), 89/336/CEE (+91/263/CEE+92/31/CEE+93/68/CEE), 2002/95/CEE, 2002/96/CEE and the EN 60335-1:2002+A11:2004+A1:2004, EN 60335-2-54:2003+A1:2004+A11:2004, EN 55014-1:2001+A1:02+A2:03, EN 61000-3-2:2002, EN 61000-3-3:1997+A1:02 and EN 50366:2003 standards.

Pegognaga 14/12/2005

Giancarlo Lanfredi-General Manager

Signature



HELP LINE GB

LAVORWASH GB

**6 Bishops Court Winwick Quay
Warrington Cheshire WA2 8QY
tel 01925-631100**

www.lavorwash.co.uk



halfords