

halfords

**HP 2800
Pressure
Washer**

Instruction Manual

Item Code: 825240

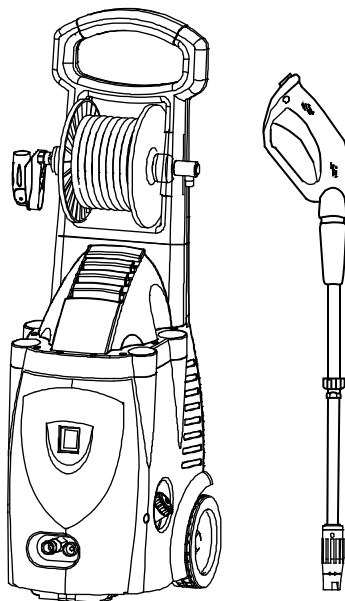

INTRODUCTION

For your safety, please read and understand this instruction manual.

Retain the manual for future reference and ensure that new users have also read and understood the instructions and warnings.

If you have any problems with this unit that cannot be rectified by using the troubleshooting section on page 9, please call our customer careline on 0845 601 7834.

Thank you for purchasing this product, which has passed our extensive quality assurance process. Every care has been taken to ensure that it reaches you in perfect condition. However, in the unlikely event that you should experience a problem, or if we can offer any assistance or advice, please do not hesitate to contact our customer careline on 0845 601 7834, please **do not return the pressure washer to the store of purchase.**

Safety first

Before attempting to operate this pressure washer the following basic safety precautions should always be taken to reduce the risk of fire, electric shock and personal injury. It is important to read the instruction manual to understand the application, limitations and potential hazards associated with this tool.

CERTIFICATE OF GUARANTEE.

The manufacturer guarantees this machine for 1 year with effect from the date of purchase. This guarantee does not cover machines intended for hire. We will replace any parts found to be defective due to a fault or manufacturing defect. The guarantee does not cover the following: consumable accessories, use for professional purposes, or misuse. Should the machine be modified in any way or used with unauthorized accessories without the manufacturer's consent the guarantee will automatically be rendered invalid. The manufacturer declines any responsibility as regards civil liability arising from misuse of the machine or failure to comply with the relevant operating, setting and maintenance instructions. Assistance under the guarantee will only be admissible if the request is addressed to the approved after-sales service centre together with proof of purchase.

As soon as you have purchased the product, we recommend that you check to make sure it is intact and that you read the operating instructions carefully before using it.

This guarantee is in addition to and in no way affects your statutory rights.



Compliant with the European directives



General warning



Read carefully



The use of safety goggles is advised



Ear protection is advised



Protect from frost



Maximum sound power level

Safety Instructions

THIS MACHINE PRODUCES A HIGH PRESSURE WATER JET, WHICH CAN BE DANGEROUS. FOLLOW ALL THE MAINTENANCE AND SAFETY INSTRUCTIONS DETAILED IN THIS MANUAL. FAILURE TO FOLLOW THESE INSTRUCTIONS COULD RESULT IN SERIOUS INJURY OR DEATH.

THE PRESSURE WASHER HAS BEEN CHECKED PRIOR TO DESPATCH. IF YOU HAVE ANY QUESTIONS PLEASE CONTACT THE CUSTOMER CARELINE.



In addition to the safety information given in this manual all other applicable general safety regulations need to be observed.



Make sure that the connection to the electric system corresponds to the latest edition of regulations and safety standards.



It is strongly recommended that the electrical power supply for this machine includes either a residual current device to interrupt power supply if dispersion current to ground exceeds 30mA for 30mS, or a grounding circuit.



Do not use the unit if the electric cable or plug is damaged. Consult a qualified electrician for repair.



Never direct the water jet at the unit itself.



Never touch the mains plug with wet hands; never work bare-foot.



Do not operate the unit in potentially explosive locations.



Before any cleaning or maintenance, the electro-pump must be disconnected from the power supply.



Do not use in the rain.



This unit is for domestic use only.



The water jet can be dangerous if used incorrectly; never direct the water jet towards yourself or others, do not clean clothing or foot wear, never direct the water jet towards animals or electrical appliances.



Never put hand or fingers over the spray tip while operating the unit.



Never try to stop or deflect leaks with any body part.



Do not let children or persons not familiar with these safety instructions use the unit.



Before start-up make sure that the lance is not open as this could release a sudden jet of high pressure water which could turn the lance into a dangerous whip.



We recommend the use of safety goggles and suitable ear protection.



Vehicle tyres/tyre valves may only be cleaned from a minimum distance of 30cm otherwise they could be damaged. The first indication of this is a discolouration of the tyre. Damaged vehicle tyres/tyre valves can be dangerous.



Never draw in solvent-containing liquids, undiluted acids or solvents! This includes petrol, paint thinners and heating oil. The sprayed vapour is highly flammable, explosive and toxic, also acetone, undiluted acids and solvents as these corrode materials used on the unit.



Use only the nozzle supplied with this machine.



Do not drive vehicles over the high pressure hose or the electrical cables. Do not kink or allow contact with sharp objects. The hose is easily damaged.



Ensure you know how to stop this product and release pressure quickly. Be thoroughly familiar with the controls.



Each time the unit is switched off, release the pressure by squeezing the trigger. Never disconnect the high-pressure discharge hose from the machine while the system is pressurized.



Used lubricants must be collected and treated in accordance with local authority regulations.



Ensure safety devices are operating properly before each use. DO NOT remove or modify any part of the gun or unit.



Do not operate the product when fatigued or under the influence of alcohol or drugs.



Always engage the trigger safety latch in the safe position when spraying is stopped even if only for a few moments. Never leave wand unattended while machine is running.



Always follow detergent manufacturer's label recommendations for proper use of detergents. Always protect eyes, skin, and respiratory system from detergent use.



Do not use pressure that exceeds the operating pressure of any of the parts (hoses, fittings, etc.) in the pressurised system. Ensure all equipment and accessories are rated to withstand the maximum working pressure of the unit.



Never permanently engage the trigger mechanism on the gun.



Never operate the machine without all components properly connected to the machine.



Always turn water supply "ON" before turning pressure washer "ON". Running pump dry causes serious damage.



Do not operate the pressure washer with the inlet water screen removed. Keep screen clear of debris and sediment.



Never operate the pressure washer with broken parts. Check equipment regularly and repair or replace worn or damaged parts immediately.



Never attempt to alter factory settings. Altering factory settings could damage the unit and will void the warranty.



Always hold gun and wand firmly when starting and operating the machine.



Never connect the pressure washer to a hot water supply, as this will significantly reduce the life of the pump.



Use of extension cords is not recommended. Use only grounded three wire extension cords intended for outdoor use. Use only extension cords having an electrical rating equal or greater than the rating of the products. Do not pull on the cord to disconnect. Always disconnect cord from receptacle before disconnecting product from extension cord.



This pressure washer has an automatic ON/OFF system. The motor on this pressure washer does not run continuously. It only runs when the trigger of the spray gun is squeezed.

Contents & Assembly

Upon opening the carton, if you do not have all the items as detailed please contact the Customer Careline 0845 601 7834, please **do not return pressure washer to the store of purchase.**

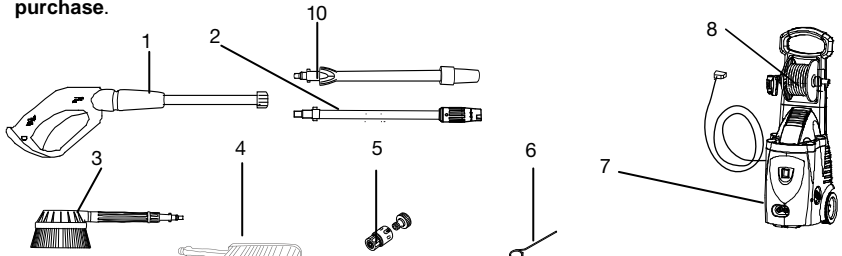

- 1 - Spray gun
- 2 - Vario lance
- 3 - Rotary brush
- 4 - Fixed brush
- 5 - Hose pipe connector
- 6 - Cleaning pin
- 7 - Pressure washer unit
- 8 - High pressure hose 10m
- 9 - Transfer hose
- 10 - Turbo lance
- 11 - Electrical cord hook(backside)
- 12 - Detergent tank
- 13 - On/off switch

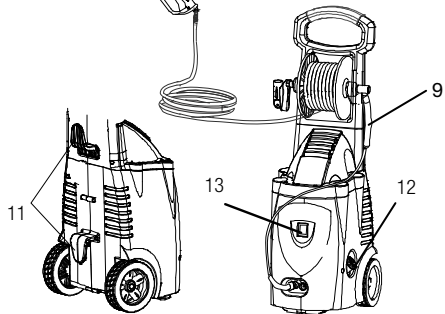

Assembly

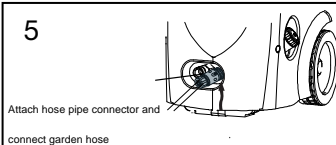
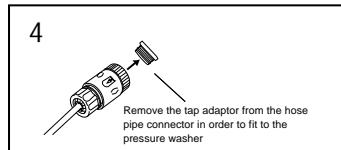
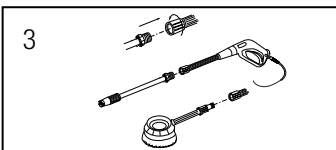
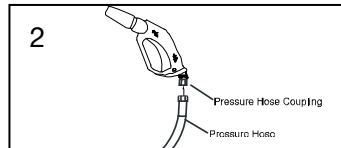
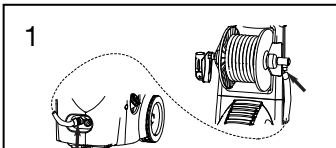

Secure all connections tightly to prevent leaks.

Unpacking

This packaging contains sharp objects. Take care when unpacking. This machine could require two persons to lift, assemble and move. Remove the machine, together with the accessories supplied, from the packaging. Do not throw the packaging away, keep it safe throughout the guarantee period then recycle if possible, otherwise dispose of it by the proper means. Do not let children play with empty plastic bags due to the risk of suffocation.

Operation

Adjusting Fan Pattern

The angle of spray coming out of the lance may be adjusted by rotating the nozzle. This will vary the spray pattern from approximately a 0° narrow high impact stream to a 60° wide fan spray (see figure 1).

The narrow high impact spray (see figure 2) must be used cautiously, as it may damage some surfaces.

Large surface areas can be cleaned more quickly using a wide fan pattern (see figure 3).

Adjusting Pressure Setting

The pressure setting can be adjusted by rotating the orange inner collar of nozzle towards + (anticlockwise) to increase water pressure and towards - (clockwise) to decrease water pressure.

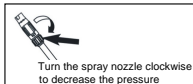

Nozzle Cleaning

A clogged or partially clogged nozzle can cause a significant reduction of water coming out of the nozzle and cause the unit to pulsate while spraying. To clean out the nozzle:

- Turn off and unplug unit.
- Turn off water supply. Relieve any pressure trapped in the hose by squeezing trigger 2-3 times.
- Separate lance from gun.
- Rotate nozzle to the narrow stream setting. This opens up the fan blades.
- Insert tip cleaner into the nozzle hole and move back and forth until debris is dislodged (see figure 4).
- Remove additional debris by back-flushing water through the nozzle. To do this, place end of a garden hose (with water running) to end of nozzle for 30-60 seconds.

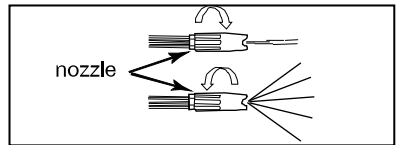

Figure 1 Adjusting nozzle for fan pattern.

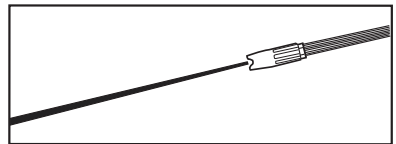

Figure 2 Narrow high impact stream.

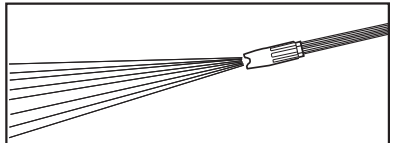

Figure 3 Wide fan pattern.

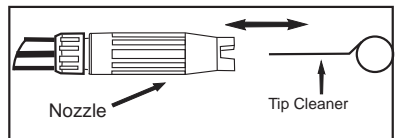

Figure 4 Insert tip cleaner in nozzle hole and move back and forth until debris is dislodged.

Angle To Cleaning Surface

The optimum angle for spraying water against a cleaning surface is 45°.

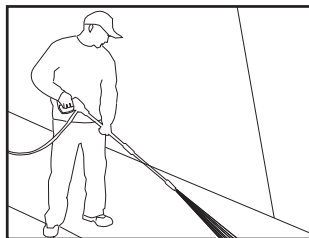

Figure 5 Optimum angle to cleaning surface

How To Avoid Damaging Surfaces

Damage to cleaning surfaces occurs because the impact force of the water exceeds the durability of the surface. Never use a narrow high impact stream or a turbo/rotary nozzle on a surface that is susceptible to damage. Avoid spraying windows with a narrow high impact stream or turbo nozzle as this may cause damage. To avoid possible damage follow these three steps:

1. Before triggering the gun, adjust the nozzle to a wide fan pattern.
2. Place the nozzle approximately 4-5 feet from and 45° to the cleaning surface, and trigger the gun.
3. Vary the fan pattern spray angle and the distance to the cleaning surface until optimum cleaning efficiency is achieved without damaging the surface.

CAUTION: Car paintwork / bodywork and other surfaces can be damaged by the high pressure jet, in particular, caution should be taken with new, damaged or unsecured paint. Damage is not covered by the warranty.

Turbo Lance

A turbo nozzle, sometimes referred to as a rotary nozzle, is a very effective tool that can significantly reduce cleaning time. The turbo nozzle combines the power of a narrow high impact stream and the efficiency of a fan pattern. This swirls the narrow high impact stream into a cone shape that cleans a larger area.

CAUTION: As a turbo nozzle uses a narrow high impact stream, only use it in applications where the cleaning surface cannot be damaged by narrow high impact spray (as above). Additionally, the turbo nozzle is NOT adjustable and cannot be used to apply detergent.

Detergents

Use specialist pressure washer detergents – household detergents may be thicker and will clog the detergent injection system.

1. Unscrew the cap beside the wheel of pressure washer to add detergent.
2. Detergent is applied to surface by using the Vario lance on the low pressure setting. To do this, twist the pressure adjustment collar on the Vario lance to the lowest pressure setting

by twisting collar clockwise towards the 'negative' symbol (see figure 6). Alternatively detergent can be applied when using a low pressure attachment with the lance, e.g. fixed brush, rotary brush.

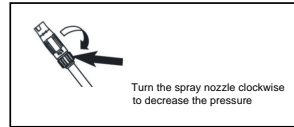

Figure 6 Adjusting pressure

3. Be sure all detergent is flushed from system after use – add water to system to do this.

Motor Protection

To prevent damage due to overheating the pump motor is fitted with a thermal switch.

If during use the pressure washer stops - turn off and unplug from the mains power supply and allow to cool for at least 10 minutes.

If the motor continues to cut out due to overheating contact the Customer Careline Number 0845 601 7834.

Shutdown

1. Be sure all detergent is flushed from the system.
2. Turn off the pressure washer at on/off switch on unit.
3. Turn off the water supply.
4. After the motor and water supply are turned off, trigger the gun to depressurise system.

CAUTION: NEVER turn water supply off before turning motor off. Serious damage could occur to the pump and/or motor.

WARNING! NEVER disconnect the high-pressure discharge hose from machine while system is pressurised. To depressurise, turn motor off, turn water supply off and squeeze gun trigger 2-3 times.

5. After each use, wipe all surfaces of the pressure washer with a clean, damp cloth.

Storage

Do not store the pressure washer outdoors. Do not store the pressure washer where it might freeze. Damage due to freezing is not covered by the warranty.

Major Technical Data

ITEM	HP 2800
Working Pressure	12.5 Mpa (125 bar)
Working Flow Rate	7.1 l/min
Max. Pressure Water Supply	0.4 Mpa (4 bar)
Motor Capacity	2800W
Power Supply Voltage	240V~50Hz
Max. Water Temperature	50°C

Troubleshooting chart

Symptom	Possible cause(s)	Corrective Action(s)
Pressure washer does not start	<ol style="list-style-type: none"> 1. Unit is pressurized 2. Plug did not well connected or electric socket is faulty 3. Extension cord too long or wire size too small 4. Main voltage supply too low 	<ol style="list-style-type: none"> 1. Squeeze trigger on gun 2. Check plug, socket 3. Remove extension cord 4. Check that main supply voltage is adequate
Pump does not reach necessary pressure	<ol style="list-style-type: none"> 1. Water inlet filter is clogged 2. Pump sucking air from hose connections 3. Nozzle worn or not correct size 	<ol style="list-style-type: none"> 1. Clean water inlet filter 2. Check that connections and locking ring are properly tightened 3. Contact customer Careline, do not return pressure washer to store of purchase
Low pressure		<ol style="list-style-type: none"> 1. Check orange pressure collar adjustment, rotate pressure adjusting orange collar anti clockwise to increase pressure (page 6)
Fluctuating Pressure	<ol style="list-style-type: none"> 1. Pump sucking in air 2. Clogged nozzle 	<ol style="list-style-type: none"> 1. Check that hoses and connections are tight 2. Clean with tip cleaner (see page 6)
Motor stops suddenly	<ol style="list-style-type: none"> 1. Extension cord too long or wire size too small 2. Thermal safety switch has tripped due to overheating 	<ol style="list-style-type: none"> 1. Remove extension cord (page 4) 2. Check that main supply voltage age corresponds to specifications 3. Turn off and unplug from the mains power supply and allow to cool for at least 10 minutes, if the motor continues to cut out due to overheating contact the Customer Careline Number 084 601 7834.
No detergent Suction – units with attachable applicators	<ol style="list-style-type: none"> 1. Detergent applicator clogged 	<ol style="list-style-type: none"> 1. Clean applicator with warm water 2. Replace applicator
Unit begins to smoke	<ol style="list-style-type: none"> 1. Overheated, overloaded or damaged motor 	<ol style="list-style-type: none"> 1. Turn off unit and contact customer careline

Recycling

This product bears the selective sorting symbol for waste electrical and electronic equipment (WEEE). This means that this product must be handled pursuant to European Directive 2002/96/EC in order to be recycled or dismantled to minimize its impact on the environment.

For further information, please contact your local or regional authorities.

Electronic products not included in the selective sorting process are

potentially dangerous for the environment and human health due to the presence of hazardous substances.



EC Declaration of Conformity

We, Halfords Limited, Icknield Street Drive, Redditch, Worcestershire, B98 0DE hereby declare that the machine described below is both in its basic design and construction and in the version marketed by us conforms to the relevant safety and health related requirements of the appropriate EC Directives. This declaration shall cease to be valid if modifications are made to the machine without our approval.

Product: Pressure washer

Model: HP 2800

Item Code: 825240

Serial number:

(to be entered by customer)

- 98/37/EEC Machinery Directive
- Low Voltage Directive 73/23/EEC at last amended by EEC Directive 93/68/EEC
- EC Council Directive 89/336/EEC at last amended by EC Directive 93/68/EEC
- 2000/14/EC Noise Directive

It is ensured through internal measures that series-production units conform at all times to the requirements of current EC Directives and relevant standards.

Signed.....

CHRIS HALL

Head of Quality & Cost Reduction

1 Nov 2007

Halfords Ltd
Washford
Redditch
B98 0DE